



Devkinandan

Harihar Singh Road, Morabadi

3D VIEW



Salient Features

1. Peaceful Location.
2. 24 hrs. water supply from own tubewell through overhead tank lifted by pump
3. Generator facility with limited electric supply to flats and to be used for running electric water pump and lift.
4. Concealed telephones lines.
5. Black/Maroon Granite in Kitchen platform.
6. Main Door with Teak/laminate finishing on external face.
7. Ultra lock in main door.
8. Intercom facilities.

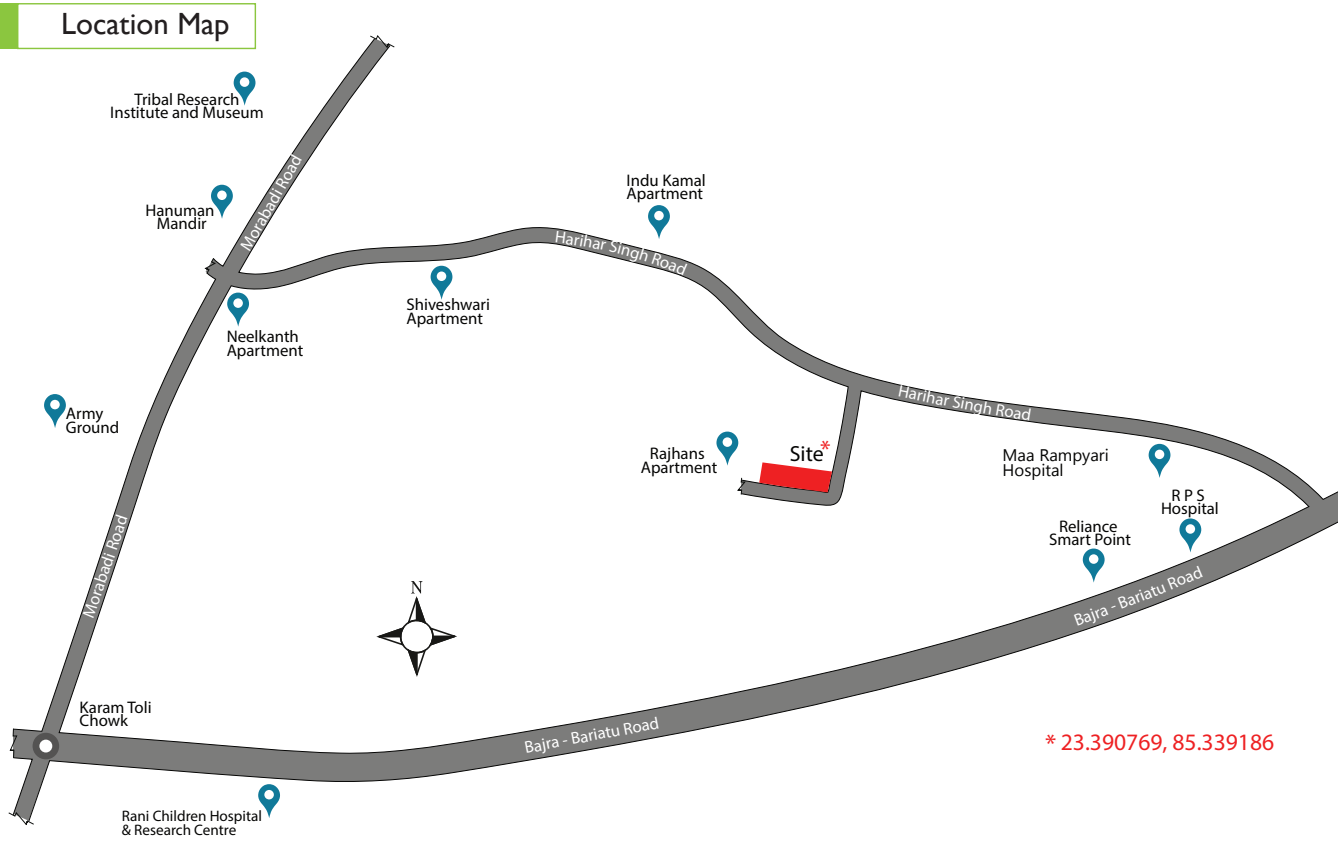

* 23.390769, 85.339186

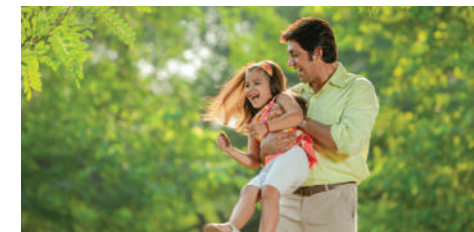

Parking Plan

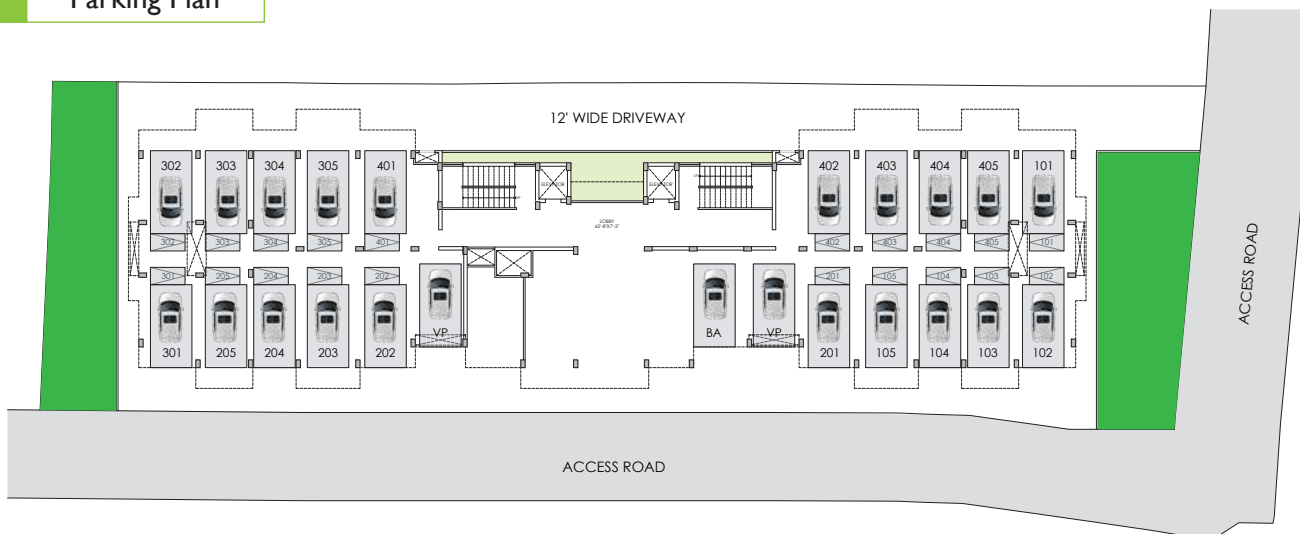

Typical Floor Plan

Devkinandan

Rera Carpet Area = 1081 Sq.Ft.
* EBVT Area = 223 Sq.Ft.
Super B/U Area = 1605 Sq.Ft.
105, 205, 305, 405

Rera Carpet Area = 1081 Sq.Ft.
* EBVT Area = 223 Sq.Ft.
Super B/U Area = 1605 Sq.Ft.
101, 201, 301, 401



Rera Carpet Area = 1113 Sq.Ft.
* EBVT Area = 223 Sq.Ft.
Super B/U Area = 1640 Sq.Ft.
104, 204, 304, 404

Rera Carpet Area = 1068 Sq.Ft.
* EBVT Area = 233 Sq.Ft.
Super B/U Area = 1605 Sq.Ft.
103, 203, 303, 403

Rera Carpet Area = 1113 Sq.Ft.
* EBVT Area = 223 Sq.Ft.
Super B/U Area = 1640 Sq.Ft.
102, 202, 302, 402

* Exclusive Balcony, Verandah & Terrace Area

ROAD

Structure :

R.C.C. column/beams slabs.

Walls

8"/6"/4" thick external & 3"/4" thick internal partition walls. All internal walls and ceiling will have plaster of Paris finish with a coat of cement primer and dry distemper over it.

Floors

Vitrified/Ceramic floor tiles in whole flat (Except Toilets) (Make size and quality as per discretion of the builder)

Doors

Wooden/WPC/MDF/HDF frame with flush/panel type shutters of wood. Ultra locking in main door and cylindrical lock in all bedrooms and toilet doors.

Windows

Three track sliding aluminium / uPVC windows with two track glazed and one track mosquito net provision.

Water Arrangement

Connection from deep tube well to overhead tank connected with electric pump.

Toilets

Flooring and dado in ceramic tiles upto chowkhat height. (Geysers not provided)

Sanitary Fittings

All C.P. or brass fittings of standard make. White glazed vitreous sanitaryware, Cistern of white acrylic fibre glass. Hot and Cold water plumbing in toilets.

Kitchen

All C.P. or brass fittings of standard make. Hot and cold provision.

Electricals

Concealed copper wiring with standard make modular fittings and fixtures. Fan regulators, provision for AC point and T.V. & Telephone point in Drawing Room and all Bedrooms and intercom facility shall be provided (A.C., Fan, Tubelights not provided)

Parking

Floor Chequered Tiles.

FLAT DETAILS

Flat No. _____

Flat Floor _____

Flat Direction _____

Flat Value _____



MODE OF PAYMENT

Initial Booking	Rs. 5,00,000/-
At the time of foundation	21%
At the time of 2nd slab casting	21%
At the time of 4th slab casting	21%
After Plaster before POP	21%
15 days before possession	Balance
Rates valid one week from	_____

- Specifications are subject to changes without prior notice.
- Registration cost, GST & other Govt. charges will be extra.
- Layout, 3D View and structure subject to change at the instance for RMC/Structural Engineer or any other regulating authority.

Carpet area shall mean and include the carpet area as per definition provided by REAL ESTATE (Regulation and Development) ACT 2016 which includes internal walls, toilets etc but excludes exterior wall and balconies.



Punit Enclave Block 'C', Tupudana, Ranchi



Jamuadag, Khunti



Shree Radhe, Dungari, Tupudana



Induneil, Kathal More



RERA REGISTRATION No. JHARERA/PROJECT/41/2025



Rameshwaram Industries

C/o Hindustan Tiles, 3rd Street, Shukla Colony, Hinoo Ranchi - 834 002

Ph.: 9431170753, 9431170287, 9431707949

website : www.adharshilaproperties.com • E-mail : adharshilainfo@gmail.com